

SHUTTLE POD MINI REFERENCE GUIDE

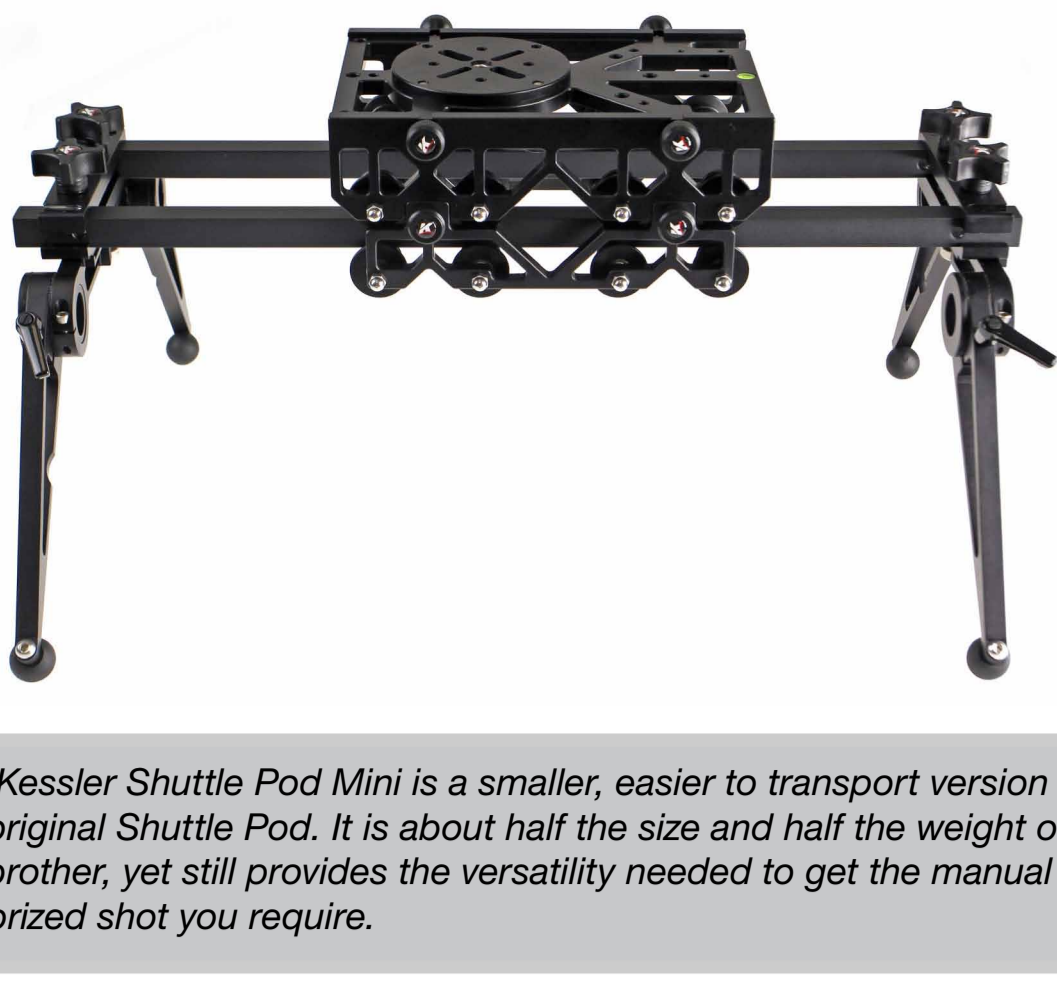

The Kessler Shuttle Pod Mini is a smaller, easier to transport version of the original Shuttle Pod. It is about half the size and half the weight of its big brother, yet still provides the versatility needed to get the manual or motorized shot you require.

CARRIAGE ASSEMBLY

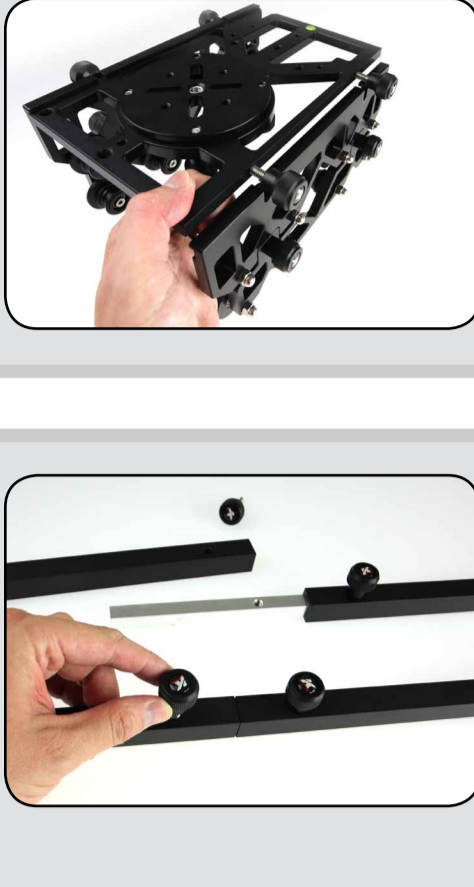

1. Locate the top plate, wheel assemblies (x2), and the 3/4" long thumb screws (x4).
2. Insert the thumb screws loosely into top plate.
3. Slide the wheel assemblies into place and tighten the 4 thumb screws completely.
4. The carriage is now assembled.

TRACK ASSEMBLY

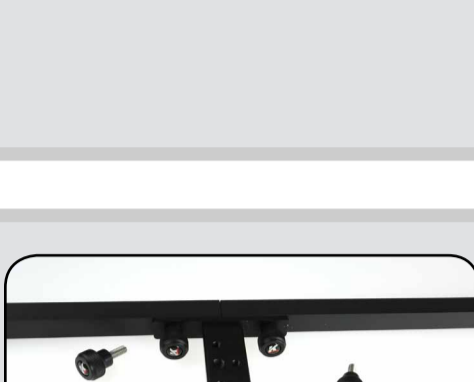

1. Locate 2 sections of track, one (1) aluminum joiner insert, and two (2) 3/4" long Kessler thumb screws
2. Insert the aluminum joiner into one section of track and loosely insert a thumb screw.
3. Insert the other track section over the other side of the joiner and install second knob.
4. Tighten both knobs to complete track joint.

INSTALLING CROSS BRACE

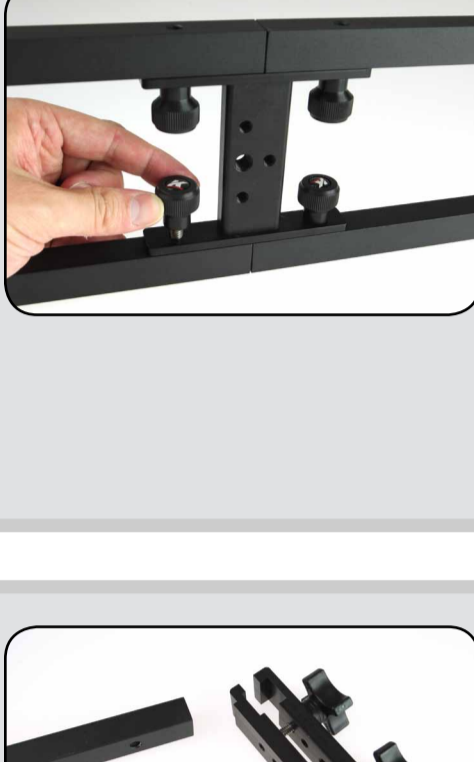

The optional cross base can be used at track joints for supporting the center of the track assembly on a tripod or other surface.

1. Remove the thumb screws at the track.
2. Insert the cross brace between track and re-insert the thumb screws.
3. Re-tighten the two thumb screws.
4. Repeat on opposite track to complete assembly.

NOTE: Track must be supported at least every 8 feet. Do not support the track at center only. Always use at least two points of support.

INSTALLING END CLAMPS

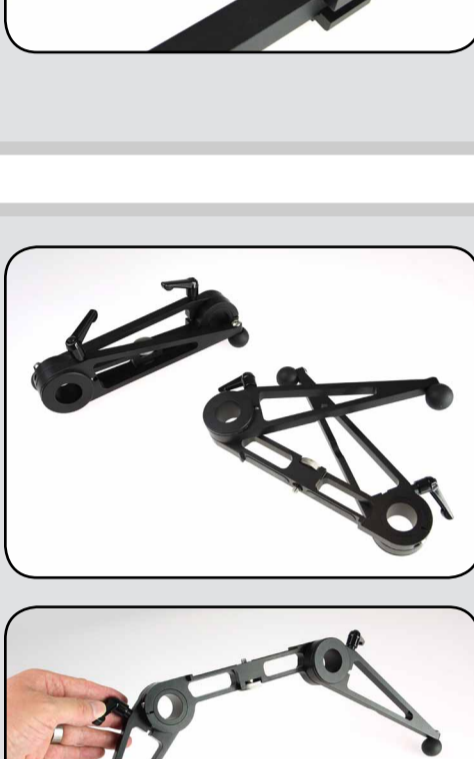

The end clamps can be used for mounting the track to tripods, all terrain feet, or other surfaces. They feature 1/4-20 and 3/8 thread mounting points.

1. Loosen but do not remove the large knobs on the end clamp.
2. Slide the end clamp over the ends of the Shuttle Pod tracks.
3. Re-tighten the two knobs.

NOTE: If you will be using the motion control kit, we recommend leaving 1-2 inches of track extending out the end for adjusting belt tension.

ALL TERRAIN FEET

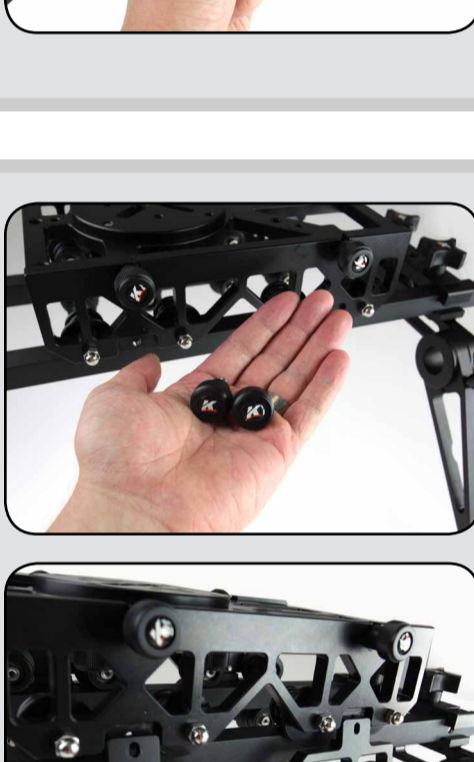

The optional Shuttle Pod Mini All Terrain Feet Kit is an adjustable foot support system that can be attached to the Shuttle Pod Mini end clamp for easy setup in a variety of locations.

1. Loosen and extend the outrigger feet.
2. Tighten the feet so they remain extended.
3. Align the 1/4" bolt inset on the top of the foot bracket to the 1/4" hole on the bottom of the Shuttle Pod Mini end clamp.
4. Slide the Shuttle Pod track into the clamp on top of the outrigger feet.
5. Re-tighten the two knobs.
6. Adjust angle of outrigger feet so assembly sits level.

MOUNTING THE KEEPER/GRABBER

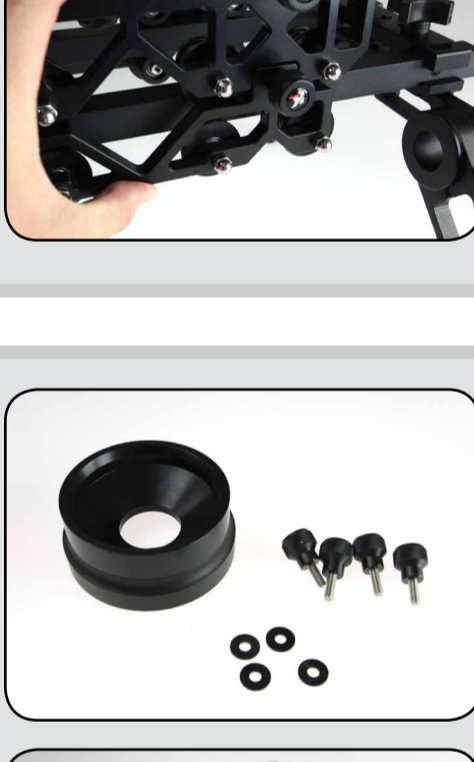

The optional keeper/grabber wheel kit is used to hold your Shuttle Pod Mini to the track when using it in an inclined or inverted configuration.

1. Locate the four (4) thumb screws and two (2) wheel skirts.
2. Align the two holes on the wheel skirt to the corresponding holes on the Shuttle Pod Mini carriage.
3. Insert and loosely tighten the thumb screws.
4. With the thumb screws slightly loose, grab the top and bottom wheel skirts and pull them together with your fingers as you tighten down the thumb screws.
5. Repeat on other side.
6. Check the carriage and make sure it travels smoothly on the track. Adjust tension between upper and lower wheel skirt as necessary.

MOUNTING THE TRIPOD BOWL

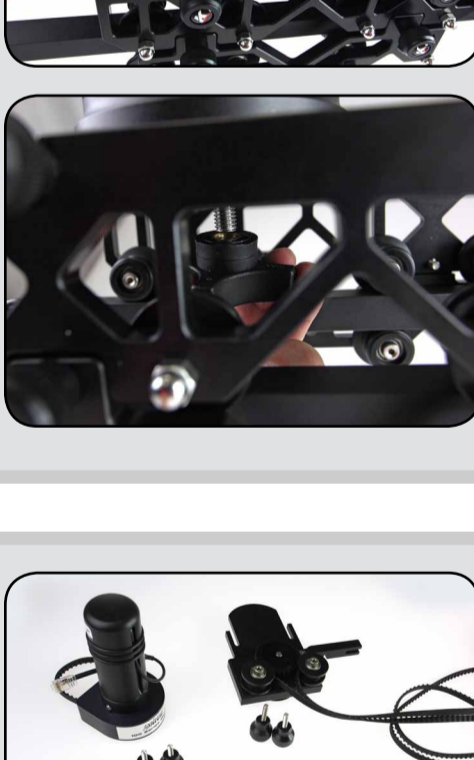

The optional 100mm bowl mount allows for mounting a 100mm ball fluid head to the Shuttle Pod. You may also mount a 75mm ball fluid head by using the optional 100mm - 75mm bowl Adapter ring.

1. Remove the four (4) 3/4" long thumb screws holding the camera cheese-plate in place.
2. Insert the 100mm bowl mount and replace the thumb screws from below.
3. Securely tighten the thumbscrews and install your 100mm bowl fluid head. Optionally you can use the large 3/8" thumb wheel for a lower profile install underneath.

MOUNTING THE DRIVE BELT



The optional drive belt kit allows the Shuttle Pod Mini to utilize the ElektraDRIVE motor for motorized motion control.

1. Locate the drive belt, two end clamps, mounting plate/belt pulley, and two (2) 3/4" fine thread thumb screws.
2. Insert the belt into the mounting plate/belt pulley.
3. Using the 3/4" fine thread thumb screws, attach the mounting plate/belt pulley to the corresponding holes on top of the Shuttle Pod Mini Carriage. Keep the belt to the inside of the Shuttle Pod Mini track.
4. Slide a belt clamp into the end of the Shuttle Pod Mini track end. There is a small dovetail slot it will snap into.
5. Loosen the belt gripper on top of the clamp. Insert the drive belt and tighten. The belt should be on the inside track side of the belt clamp.
6. Repeat the process on the opposite end of the track. Pull the belt tight before tightening the belt gripper.
7. Once the belt is installed, you can loosen one of the end clamps on the track and slide it as necessary to adjust belt tension.

MOUNTING THE ELEKTRADRIIVE



The ElektraDRIVE motor is attached to the mounting plate / belt pulley. The motor is powered via one of the Kessler Control units such as the ORACLE.

1. Locate two (2) 1/2" fine thread thumb screws.
2. Loosely insert the screws into the ElektraDRIVE motor
3. Slide the motor into the mounting plate.
4. Pull the motor belt over the mounting plate's pulley and then left the motor up to create tension on belt.
5. Tighten the two (2) thumbs screws to secure the motor in place.

USING THE PEDESTAL FEET

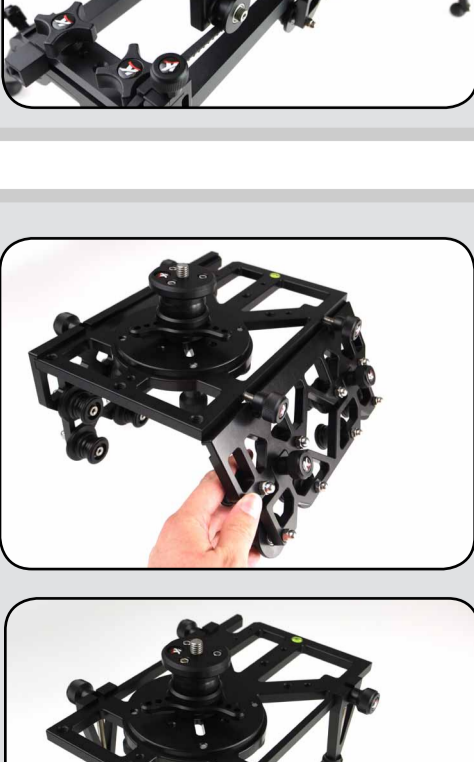

The Shuttle Pod Mini carriage top plate can be mounted to the optional pedestal feet. They can be used to set the top plate on the ground when converting the Shuttle Pod Mini to a winch system or using as a low mount shooting platform.

1. Loosen but do not remove the thumb screws securing the Shuttle Pod Mini Wheel skirts.
2. Remove the wheel skirts and install the Pedestal Feet in their place.
3. The top plate can now be used as a ground level mounting platform.