

GY-HM200SP Additional Functions

Please read this together with the "INSTRUCTIONS".

Score Overlay

This camera recorder enables single-camera sports coverage producing real-time score overlays on recorded or streamed HD video. It is available when a recording resolution is 1920×1080 or 1280×720.

Selecting the Scoreboard Type

Press [MENU] button of the camera recorder to display the menu screen, and then select a scoreboard type in [Main Menu] → [Overlay Settings] → [Type]. Then press [MENU] button to close the menu screen. There are following types for selection.

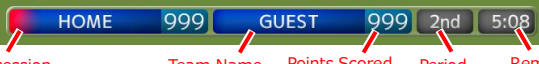
- Type 1: 

Possession Team Name Points Scored Period Remain Time
- Type 2 : 

Team Name Games Won Points Scored Set
- Football : 

Possession Team Name TOL Points Scored Period Remain Time Down & Distance
- None : None-displayed

Inputting Scoreboard Data

1. According to "Connecting to the Network" in the "INSTRUCTIONS" stored in the CD-ROM or the Mobile User Guide (<http://manual3.jvckenwood.com/pro/mobile/global/>), connect a network device such as a smartphone or a tablet with the camera recorder via network. And then, launch a web browser of the network device.

2. Input the following URL in the address field of the web browser.

`http://"IP address of the camera recorder"`

Example: `http://192.168.0.1`

You can find the "IP address of the camera recorder" by the following procedures.

- (1) Press [STATUS] button of the camera recorder to display the status screen.
- (2) Use the cross-shaped button (◀ ▶) to display the [Network] status.
3. Input a username (jvc) and a password (default: 0000) on the login screen. And then, press the [Overlay Control] button on the web page to move to a score input page.
4. The web browser displays the following screen corresponding to the [Type] of the camera menu. Data other than numerical values will be updated immediately in the score overlay without need to press the "Update" button.

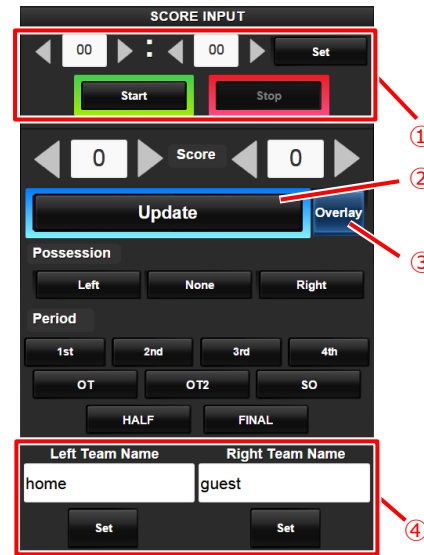

Type 1

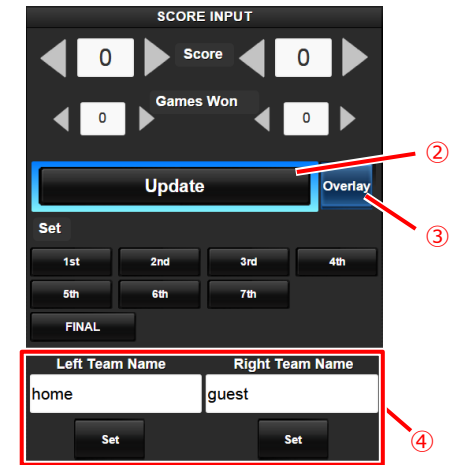

Type 2



Football

Memo :

- ① Time
The input initial time for count down is reflected to the score overlay by pressing the [Set] button. (The time on the web browser does not count down.)
 - ② [Update] button
Reflects numerical values such as points scored and a distance
 - ③ [Overlay] button
Turns the score overlay on or off.
 - ④ Team Name (for text input)
You can input numbers and letters. It is not available when [Main Menu] → [Overlay Settings] → [Layout] is set to "User".
- Press the [DISPLAY] button to switch the display screen type if the score overlay is hard to see due to the display screen.

Team Setting

Team names can be displayed by one of the following way:

- **Inputting a text with a web browser.**
- **Importing an image including a team name and logo**

Inputting a text with a web browser

You can input the team name from a web browser after [Main Menu] → [Overlay Settings] → [Layout] is set to “Default”.

Importing an image including a team name and logo

You can overlay a team logo image as a team name instead of inputting text by importing a data file to the camera. This data file (SDP file) can be generated by the PC/Mac application named SDP Generator, and the maximum number of team names that it is possible to store is 30. Please refer to the following GY-HM200SP URL about SDP Generator.

http://pro.jvc.com/prof/attributes/features.jsp?model_id=MDL102399

Caution:

Please confirm content and font licenses in the team image before use.

1. Copy a SDP file generated by SDP Generator into a root folder of a SDHC/SDXC card. A SDP file name length must be 8 or less. Also the filename extension must be “.sdp”.
Example: “overlay1.sdp”
2. Insert this SDHC/SDXC card to slot A or B, then select [Main Menu] → [Overlay Settings] → [Import User Layout]. The existing SDP data in the camera will be overwritten after importing.
3. The SDP files in a root folder of slot A and B are displayed (max. 8 files each). Select a SDP file you want to import and execute “Import”. Import takes about 20 – 30 seconds.

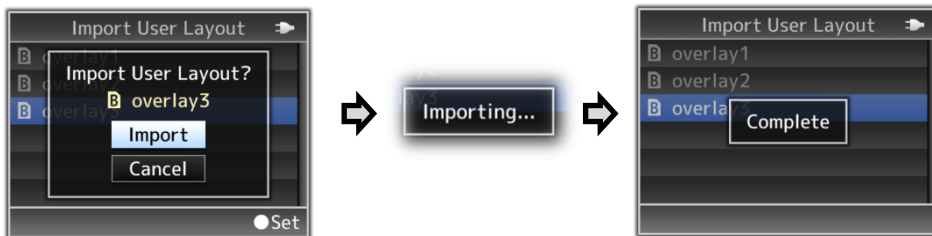

If it failed, the following message is displayed.

Error Message	Status	Action
Failed To Read File From Media!	Card is broken. SDP file data is invalid.	• Use other card. • Use SDP file generated by SDP Generator.
No User Layout Exists.	SDP file data is invalid.	Use SDP file generated by SDP Generator.
Failed To Write File To The Camera!	There may be a problem of the camera.	Please contact the local dealers in your area.
Import Error!	An internal error has occurred.	Please contact the local dealers in your area.

4. In order to apply the imported SDP file to the overlay, set [Main Menu] → [Overlay Settings] → [Layout] to “User”. If a valid SDP file has not imported to the camera, the “No User Layout Exists.” message appears. In this case, please import a valid SDP file in [Import User Layout].
5. You can select team name images in [Main Menu] → [Overlay Settings] → [Left Team] (*) or [Right Team] (*).
* This menu item names can be changed by the setting of SDP Generator.

JVC