

Kessler Pocket Jib™ TRAVELER

MADE IN USA



POCKET JIB TRAVELER REFERENCE GUIDE

The **Pocket Jib Traveler** is Kessler's newest and most compact Pocket Jib designed for shooters that require an ultra-portable jib solution. The Pocket Jib Traveler is 27 inches in length when collapsed and has a circular travel distance of 72 inches when fully extended. It surpasses other ultra-portable jibs through its unique design and light footprint, providing shooters with the perfect travel companion as they trek through extreme environments to capture the perfect shot.

Quick Specs:

Weight: 5.5 lbs.	Collapsed Length: 27"
Weight Capacity: 10 lbs.	Circular Travel: 72"



STANDARD TRIPOD MOUNTING

Whether it be with our patented Kwik Release system or a standard tripod, you'll be up and running in no time with the variety of mounting options.

1. The mounting base has both 3/8"-16 and 1/4"-20 threaded holes for mounting.
2. If possible, use at least two mounting points to prevent spinning when the jib is in use.
3. The Kessler Kwik Release system is the perfect companion to the Pocket Jib Traveler
4. Lock the tripod plate securely and check mounting thoroughly before adding your camera or counter weights.

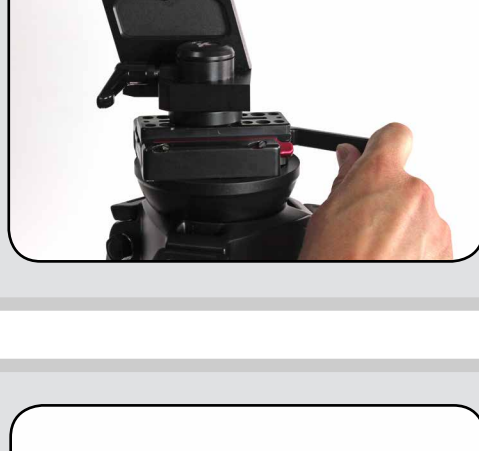

TRIPOD MOUNTING WITH BALL KIT

Our optional 100mm Ball Kit with 3/8"-16 stud is the recommended mounting method for the Pocket Jib Traveler. This will provide the most stable setup for 100mm and 75mm (with adapter) bowl tripods.

1. Remove the rubber handle and bowl cup from the bottom of the 100mm Ball Kit.
2. Tighten the drag control on the Pocket Jib Traveler so it does not spin when mounting the ball kit.
3. Thread the top 3/8" stud into the bottom of the of the jib and tighten.
4. There is a threaded hole in the bottom of the Ball Kit for preventing the jib from spinning. Use the included hex key and anti-spin grub screw and tighten to prevent the jib from spinning on the ball head.
5. Insert the assembly into your tripod bowl. Slide the bowl cup over the screw, install the rubber handle and tighten.

NOTE: The bowl cup can be mounted "flat side up" if you need to prevent the jib from pivoting in the bowl.

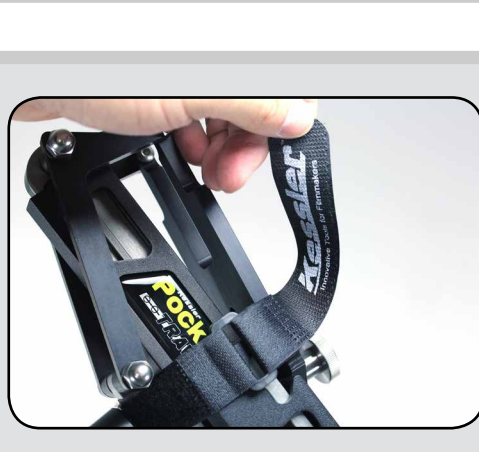
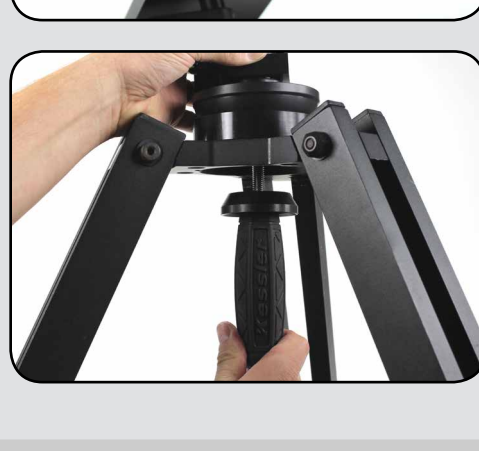

UNFOLDING THE JIB

The Pocket Jib Traveler is completely self contained in a 27" bundle and does not need to be taken apart for travel. It easily unfolds for quick use.

1. Release the velcro strap on the end of the Pocket Jib Traveler.
2. Unfold the rear arm and swing it back to align with the front arm.
3. Straighten the hinge on the rear arm and slide the whole assembly forward into the front arm.
4. Tighten the locking knob to secure the front and rear arms together.

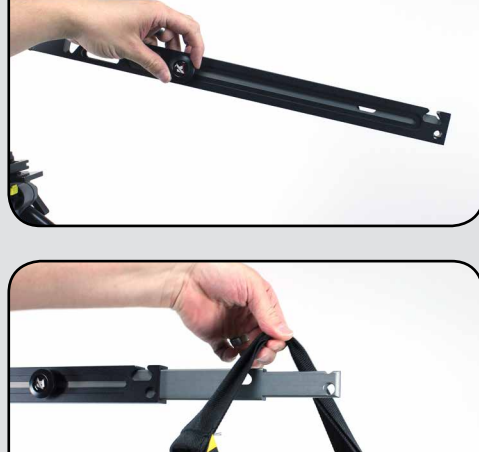
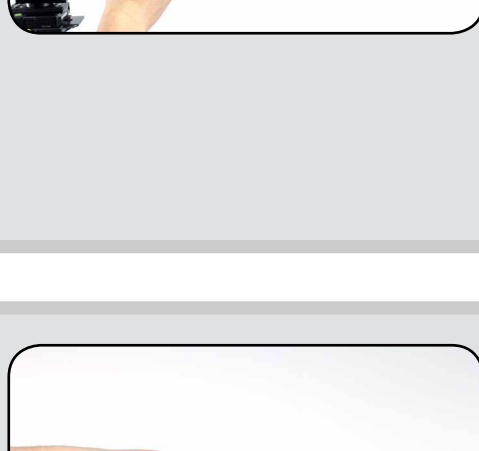
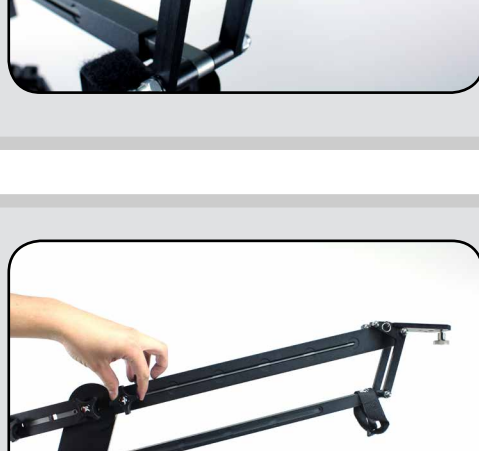

UNFOLDING THE CAMERA BASKET

A center-mounted camera platform makes camera mounting more stable and seamlessly integrates with the Kessler Kwik Release. You can also use the provided 1/4"-20 camera screw to keep camera mounting simple yet effective.

1. While pulling the locking pin, flip the camera basket forward.
2. Release the locking pin to secure the camera basket in place.



EXTENDING THE JIB

The Pocket Jib Traveler has a circular travel distance of 72 inches when fully extended. It can be locked at six different height increments.

1. Loosen but do not remove the two (2) knobs holding the upper and lower jib extension arms.
2. Extend the jib to the desired height and tighten the knobs making sure they are seated in one of the six locking recesses.

NOTE: Both locking knobs should be in the same relative position. Simply count the number of locking notches and make sure each knob is in the corresponding number on both the upper and lower arm.

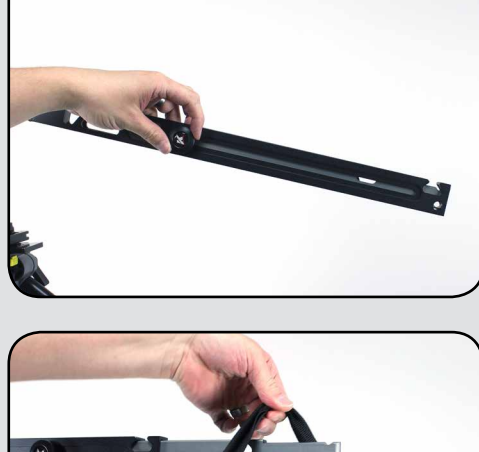

USING THE WEIGHT BAR

The Pocket Jib Traveler's sliding weight bar reduces the overall counter-balance weight needed to balance the jib, thus reducing the required load necessary for your shoots.

1. Loosen but do not remove the round knob holding the weight bar and extend to expose the weight hanger.
2. The notch on the weight bar can be used for hanging counter weights such as sand bags or water jugs.
3. To use standard weights, remove the spring release clamp from the storage knob on the front of the Jib.
4. Slide the weight over the weight bar and secure it in place with the spring release clamp. Note, there is a notch on the back of the weight bar that will catch the clamp should it slide
5. Attach your camera rig to the camera cradle. Use the included 1/4-20 screw, the Kessler Kwik Release system, or any other accessory designed for camera mounting.
6. Adjust the weight bar forward and backward to fine tune the balance of the Pocket Jib Traveler.

NOTE: We recommend using hard weights. Counter weights such as sand bags can cause sway and bounce in the jib. Using hard weights mounted directly to the weight bar will produce the best results.

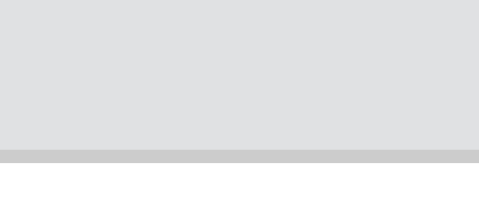
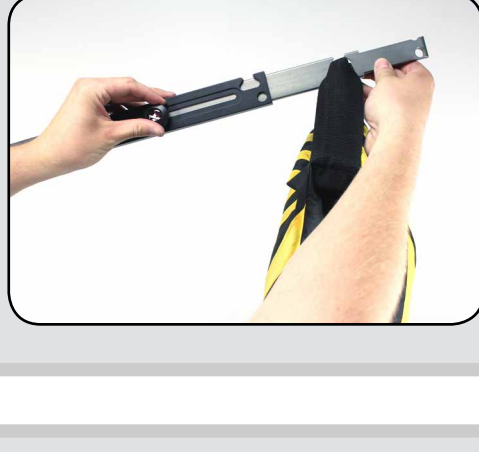
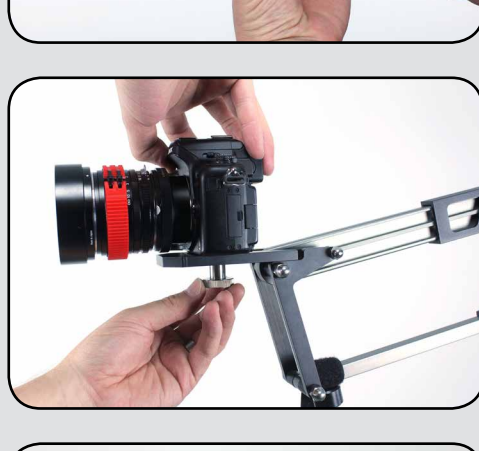

DRAG CONTROL

The Pocket Jib Traveler has drag control for both up and down and side to side movement.

1. To adjust the drag on up and down movements, adjust the tension on the top knob of the jib's fulcrum point. Use this ONLY for drag control. It is not designed to act as a brake for an un-balanced jib.
2. To adjust drag on side to side movements, use the ratcheting lever located on the clamp just above the mounting point of the jib.

NOTE: It is important that your jib setup is properly balanced before use. Do not use the drag control to compensate for an unbalanced configuration.

