

# POWER DISTRIBUTION CENTER

Universal Power Solution for Mobile Video

datavideo

## PD-3

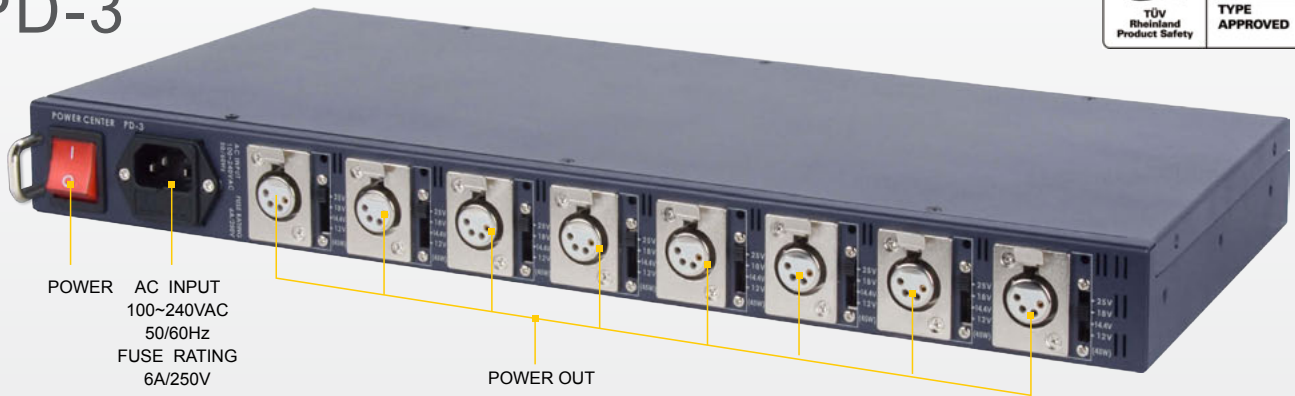

The Datavideo PD-3 is a 19" rack mountable universal AC to DC power distribution center, designed to supply a steady user chosen voltage for production kit whilst on location or in your studio.

Perfect for use in conjunction with Datavideo Mobile Video Studios equipment such as the MS-900, and the CB-22 / CB-23 all in one cable.

Each of the eight outputs can be configured individually, DC25V, 18V, 14.4V & 12V, with a total power consumption of 360 Watts.

### FEATURES

- Automatically adjusts to work with 50Hz or 60Hz supplies between 100-240 VAC.
- Eight DC outputs with a combined total power consumption of 360 Watts
- Each DC output can be switched to provide either 12, 14.4, 18 or 25 Volts
- Each DC output has a multi-colour LED confirming the chosen voltage by colour
- The unit is designed to provide both DC & AC overload protection
- Carry the global recognised UL & TUV product certification
- Standard 19" – 1U rack mountable case

### SETUP DIAGRAM

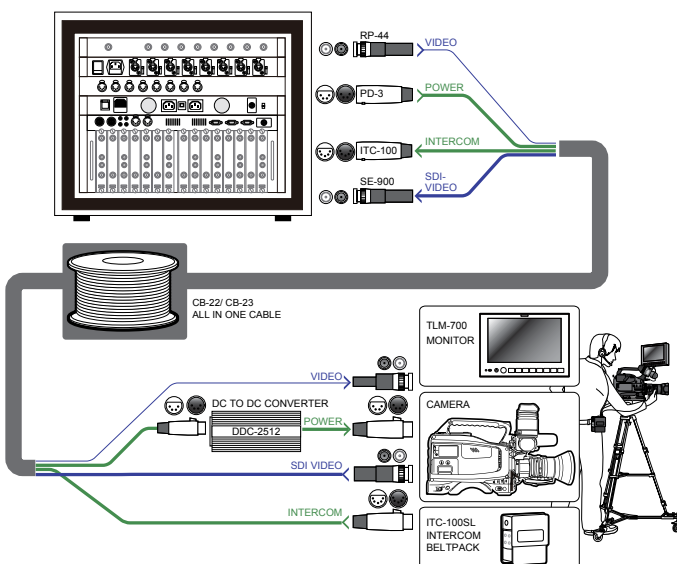

### SPECIFICATION

<b>■ AC Input:</b>	
Voltage Range	100-240 VAC
AC frequency	50Hz or 60Hz
Fuse Rating	6A/250VAC
Efficiency(Typ.)	UP TO 80%
<b>■ DC Output:</b>	
DC Voltage	12V,14.4V,18V,25V
Voltage Tolerance	±3%
Rated Current	12V(3.5A),14.4V(3A),18V(2.5A),25V(1.8A)
Current Range	0-3.5A
Rated Power(Max)	45W / one group
<b>■ Protection:</b>	
DC Overload	105%~150% rated output power Protection type: Recovery automatically after fault condition is removed
AC Overload	non-recovery fuse on the AC input outlet
<b>■ Connector:</b>	
On/Off Switch	Powers the PD-3 On / Off Light switch indicator
AC in outlet with built-in fuse	AC Inlet for connecting to suitable mains power outlet – 100-240VAC. The socket contains a fuse holder fitted with a 6A /250V fuse.
4PIN XLR Female	8 Groups DC OUTPUT:(PIN1:GND , PIN2/3:NC , PIN4:VCC)
Slide Switch	8 Groups Switch: There are four options for each group:12V,14.4V,18V,25V DC output
<b>■ Environment:</b>	
Working Temp	0°C to 40°C (32°F to 102°F)
Working Humidity	10% to 90% (non condensing)
Storage Temp. Humidity	-40°C to +85°C, 10~95% RH
<b>■ Others:</b>	
Cooling Fan	Two built-in cooling fans, please ensure that these are not blocked, and that some airflow is available.
DC Output LED Indicator	LED Color Indicator: White:25V, Red:18V, Green:14.4V, Blue:12V
Dimension	440(L)x235(W)x46(H)(mm)
Weight	5.2KG
Ground Terminal	When connecting this unit to any other component, make sure that it is properly grounded by connecting this terminal to an appropriate point. When connecting, use the socket and be sure to use wire with a cross-sectional area of at least 1.0 mm <sup>2</sup> .